

VELOCETTE WAY, NORTHAMPTON, NN5

£170,000 | 1 Bed House - Mid Terrace

BELVOIR!



Belvoir Estate Agents are delighted to offer for sale this one bedroom terraced house located in the desirable St Giles Park area of Duston. The accommodation briefly comprises entrance hall, open plan kitchen/lounge/diner, first floor landing, double bedroom with fitted wardrobes and a bathroom. The property further benefits from double glazing, electric heating, driveway, rear garden and no above chain.

- One Bedroom
- Terraced House
- Driveway
- Rear Garden
- No Above Chain
- Desirable Location
- Double Glazing
- Electric Heating

COUNCIL TAX BAND: A

Draft Details.

At the time of print, these particulars are awaiting approval from the vendor(s).

Disclaimer.

We endeavour to make our sales particulars accurate and reliable, however, they do not constitute or form part of an offer or any contract and none is to be relied upon as statements of representation or fact. Any services, systems and appliances listed in this specification have not been tested by us and no guarantee as to their operating ability or efficiency is given. All measurements have been taken as a guide to prospective buyers only, and are not precise. If you require clarification or further information on any points, please contact us, especially if you are travelling some distance to view. Fixtures and fittings other than those mentioned are to be agreed with the seller by separate negotiation.

VELOCETTE WAY, NORTHAMPTON, NN5

£170,000 | 1 Bed House - Mid Terrace

BELVOIR!

Energy Efficiency Rating

	Current	Potential
Very energy efficient - lower running costs		
(92 plus) A		92
(81-91) B		
(69-80) C		
(55-68) D		
(39-54) E		
(21-38) F		
(1-20) G	45	Not energy efficient - higher running costs

England & Wales

EU Directive

2002/91/EC

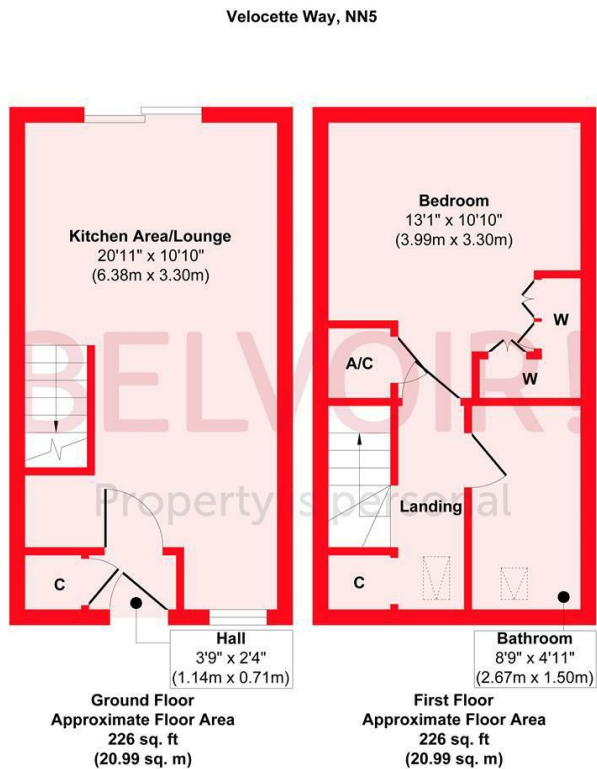

Approx. Gross Internal Floor Area 452 sq. ft / 41.98 sq. m
Illustration for identification purposes only. Measurements are approximate, not to scale.
Produced by Elements Property

